



Priest in Charge - St Martin Knowle

CONTENTS

From the Bishop of Bristol	Page 3
The Diocese of Bristol	Page 4
Message from the Area Dean	Page 6
Introduction	Page 7
The Church and Parish	Page 10
Meet the Team	Page 11
Life as a Church	Page 12
Provision for Children and Young People	Page 15
Pastoral Care	Page 16
Green Action	Page 17
Community and Outreach	Page 18
Connections with Local Schools	Page 19
Buildings and Finance	Page 20
The Vicarage	Page 21
Church Finances	Page 23
Person Specification	Page 24
Parish Contact	Page 28



St Martin, Bishop of Tours



FROM THE BISHOP OF BRISTOL

St Martin Knowle is a flourishing church in south Bristol, a part of the city which, because of its proximity to the City Centre and Temple Meads station, is developing rapidly. With deep roots in the modern catholic tradition its worshipping community has grown because of its prayerful sacramental inclusiveness. Its previous incumbent is now the Archdeacon of Bristol and its previous curate is now Associate Priest at St Mary Redcliffe. This is a parish which supports its clergy to grow into God's and the church's call. It is therefore a parish suited to clergy in a first post of responsibility who will love and be loved in a church where change and growth are welcomed. The Diocese of Bristol, and the vision of Transforming Church. Together, give confidence to each and every parish of continued investment and commitment to following Jesus, serving others and transforming community. That will continue through the forthcoming vacancy in See and into God's future.

The Deanery of Bristol South has until recently enjoyed its reputation as somewhat detached from the city and diocese, just as Bristol south of the river more generally has been detached and indeed overlooked. But changes in churches and in the wider community are increasingly evident and the cry of the poorest is being heard across the diocese. It would be vital for the new priest to continue to contribute to

and be blessed by the close and supportive Deanery clergy community, not least to support those clergy embedded in some of our Priority Communities adjacent to St Martin's parish. The patronage of Martin, in his deeply prayerful love and compassion for the needy, might be a model for you as you consider Christ's call to this parish.

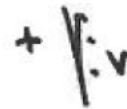

The Rt Revd Vivienne Faull
Bishop of Bristol



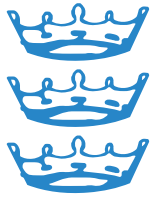

THE DIOCESE OF BRISTOL

Transforming Church. Together began in 2021 with listening to God and to one another.

From these conversations, three priorities were discerned: Following Jesus, Serving Others, Transforming Communities. Alongside these, our four guiding values - Creativity, Openness, Bravery and Generosity - inspire a vision and strategy which seeks transformation across the whole Diocese by the grace of God. Each Deanery and Benefice is encouraged to work out what T.C.T means in their particular context – the same principles can inspire and develop mission in very different ways.

With major financial support from the national church, the Diocese is offering support and resources in key priority areas of ministry.

These include:

- Enabling parishes to discern and implement vision
- Help for benefices with evangelism and discipleship
- Support for teams running New Christian Communities
- Volunteer training
- Supporting parishes with the care and improvement of church buildings
- Investing to become a Net Zero Diocese by 2030
- Addressing the church's history on racial justice and diversity

- Developing partnerships between the church and local communities
- Investment in under 18s work
- Investment in priority community parishes, church plants/grafts and Mission Areas

This is a huge and exciting vision, which we can only attempt in the strength Jesus supplies through his Spirit.



DIOCESAN SUPPORT SERVICES (DSS)

The DSS exist to support the mission of the church. Based at the Diocesan Office to the north of Bristol and made up of 50 employees and volunteers, the DSS serve ministers, parishes and schools by expressing vision, strengthening relationships, empowering people, maximizing resources and developing structures. We offer training, consultancy and advice. We manage many structural elements of the life of the Diocese.

BEING CLERGY IN THE DIOCESE OF BRISTOL

Pastoral care is a key priority for Bishop Viv and Bishop Neil. They are supported by the Archdeacons, Area Deans and the Adviser for Clergy Wellbeing. Alongside any one to one issues as they arise, an annual clergy wellbeing survey enables themes affecting clergy and their families to be identified and addressed as appropriate.

There are additionally many ways in which clergy are supported in their roles. Every incumbent is invited to work with a coach as part of the Transforming Church. Together strategy. The Adviser for Parish Development is able to work alongside clergy where support is needed to develop a focus for vision or mission. For those in positions of first responsibility additional targeted support and development is offered. The Mission and Ministry Support Team offer regular ministerial development for clergy and laity, and the Archdeacons with the support of the TC.T team, offer a church teams day each year, primarily aiming to resource church officers in their roles.

The property team are working through a programme where every parsonage house will reach carbon net zero, which, as well as reducing carbon emissions should also reduce utility costs. They are also on hand to support clergy with any issues with their homes.

There could be occasions where unexpected financial pressure arises, and the Archdeacons are able to signpost clergy to appropriate means of support, as well as accessing a discretionary fund where necessary to alleviate financial concern. These situations are responded to in confidence and clergy are strongly encouraged to contact the relevant Archdeacon if such circumstances arise.

MESSAGE FROM THE AREA DEAN

I'm delighted that you are exploring a call to St Martin's, Knowle: a thriving church in the modern Eucharistic-centred tradition that offers a warm welcome to everyone. We are seeking someone who feels at home in this tradition and also in more contemporary or contemplative styles of worship, such as Café Church. St Martin's has a strong team already in place, with excellent lay involvement, and we are looking for someone to walk alongside them and lead and guide them as they seek to discern Christ's call upon their congregation and parish at this time.

There is the potential here for further developing ministry to children and young people, building on the strong foundations already in place, and also for continuing to strengthen connections with the broader parish. St Martin's could be the ideal post for a new Priest-in-Charge with a real heart for their local community and a passion for discipleship, and for someone who is talented at enabling and encouraging others in their ministry.

It is a real privilege to be Area Dean of Bristol South Deanery. We recognise that our Deanery has its challenges—most of the parishes fall into the top third of the Index of Multiple Deprivation. However, those who live and work in this Deanery really value community and relationships. You would be joining a Chapter that has a strong emphasis on supportive, collegial relationships, that recognises how

important it is to pray together and ensure that everyone is heard. We would make you very welcome here.

This is an exciting post, in a church that is warm, welcoming and growing, and ready to see where God is calling them next.

With every blessing as you explore this post,

[Sarah Hancox](#)

[Area Dean of Bristol South Deanery](#)

INTRODUCTION

Welcome to St. Martin Knowle Parish Profile. We hope it will give you a 'flavour' of life in our church and the community we are privileged to serve. We pray that through reading the Profile and the associated documents in the application pack, you will get a sense of whether God is calling you to be our next Priest in Charge; leading, encouraging, guiding and joining in with us on the journey:

'To be a beacon of God's love and light in our local community'

'Christ's Call to St. Martin's builds on our existing vision and was drawn up following a series of workshops and meetings, involving a range of people, who have a connection with the church. These were facilitated by The Ven. Christopher Bryan, Archdeacon of Malmesbury and the Revd. Rosy Ashley, Adviser for Parish Development, between September and December 2024.

CHRIST'S CALL TO ST MARTIN'S KNOWLE

Values:

St. Martin's is a place of...

Belonging: Every individual matters, is welcome and accepted as they are.

Growing: Becoming more like Christ as we explore faith together.

Living: Demonstrating Christian values in action.

Worshipping: Gathering to draw closer to God in mystery, awe and reverence.

We are committed to being...

- a safe place of spiritual refuge for everyone in the local community
- a place to explore faith and spirituality
- a church that worships with modern expressions of ancient traditions
- a space for the community to gather, grow and learn together

Our Mission:

To be a beacon of God's love and light in our local community.



We currently do this by:

- Worshipping in a variety of styles, both in line with our eucharistic centered tradition and newer expressions, such as Café Church.
- Reading the Bible to grow our faith and relationship with Christ in smaller groups, particularly in Friday Morning Prayer and during Lent and Advent.
- Working with children and young people through Messy Church, our Sunday morning group, an ecumenical Youth Alpha and our connection with our local primary school.
- Offering hospitality as an expression of God's abundant love, involving food where we can.
- Opening our weekly community café; a warm and welcoming space to all.
- Reaching out to our community through our Christmas Hamper project and our monthly visit to a local care home.

In the future we hope to:

- Become an inspiring place of discipleship where people can talk openly about faith and the Bible.
- Grow in spirituality and prayer and develop personal faith which transforms the way we live.
- Improve our all-age worship so everyone can be involved and engaged
- Initiate new activities and groups for young people, particularly for local teenagers
- Establish better connections in our community, working together with other local organisations, to help people to thrive and live life to the full



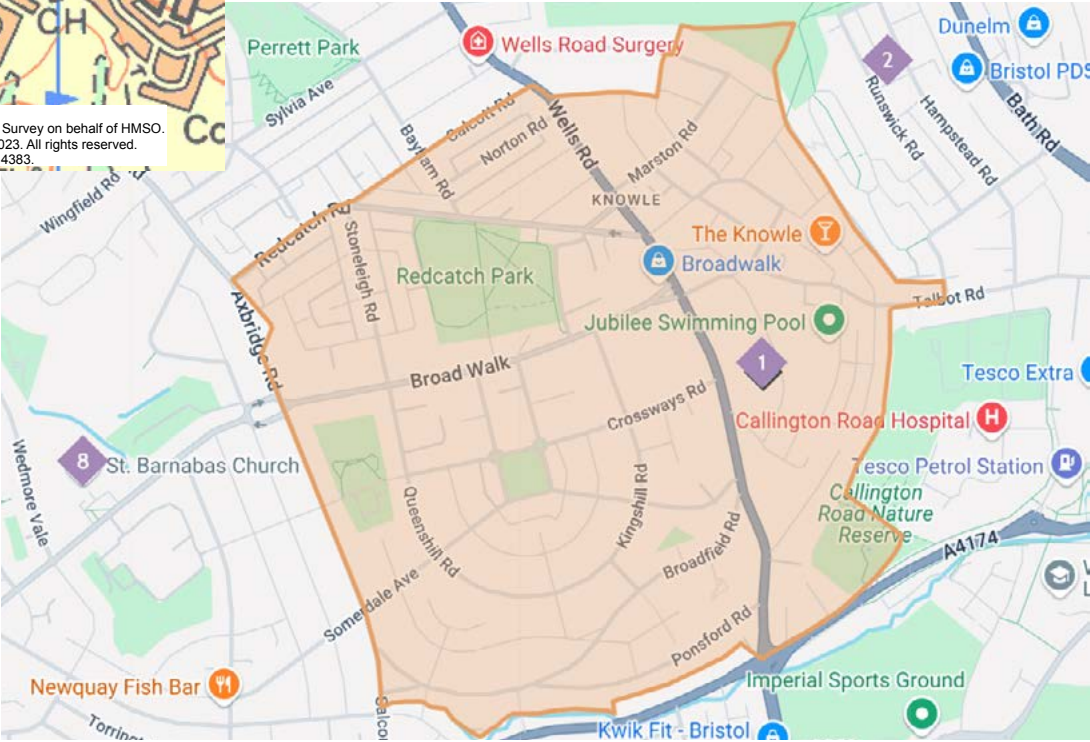
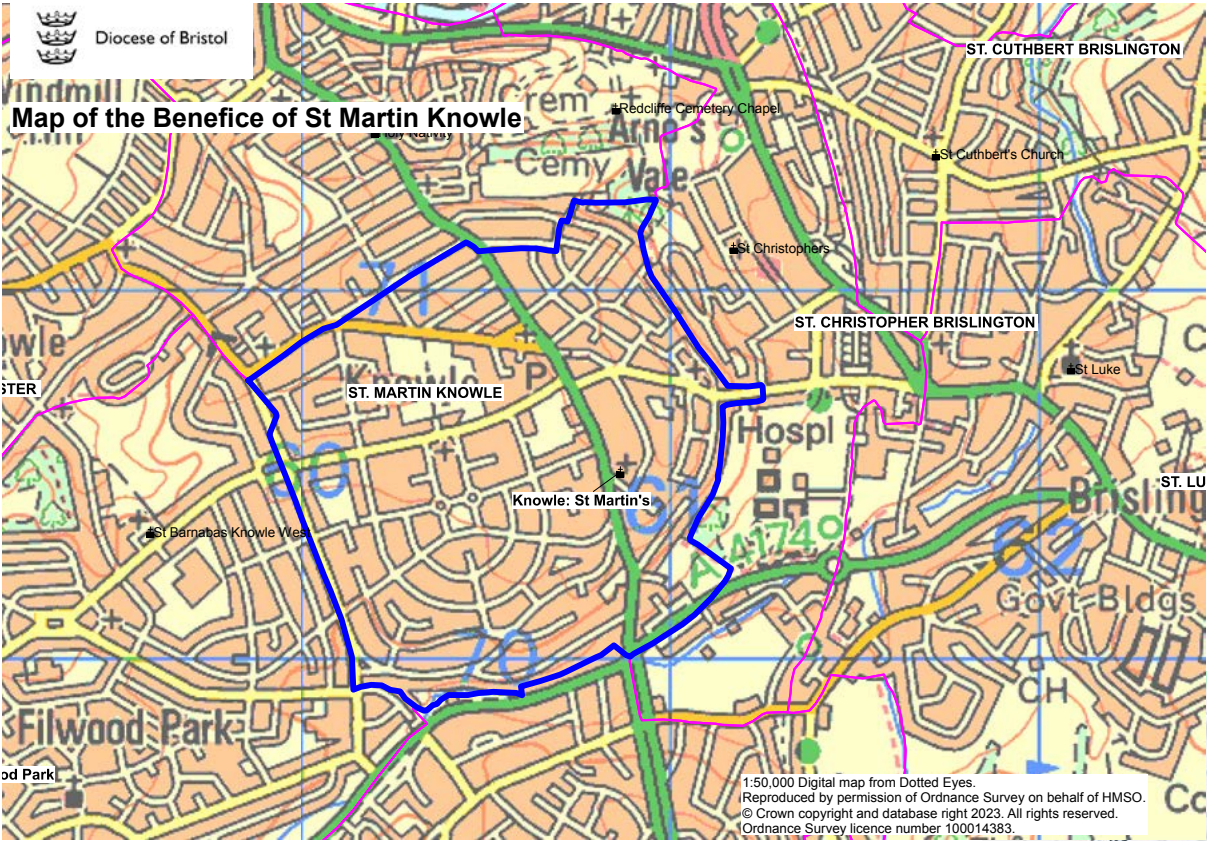

THE CHURCH AND PARISH

Sitting astride the Bristol to Wells Road, in close proximity to both Bristol's vibrant cultural life and the peace of the countryside, St Martin's is a compact parish serving 7,946 people. The church was dedicated in 1901 and then extended in 1940. There are currently 126 people on the electoral roll.

Most residents in the parish own their properties, many of which were built between 1900 and 1940. For many years the population of the parish was fairly static. It is now more varied, as young professionals and families have moved into Knowle attracted by its proximity to the city centre, good transport links and access to good schools. What had traditionally been seen as an old fashioned and ageing part of Bristol, has been transformed today into a more vibrant and diverse local community. These changing demographics are apparent in St Martin's, with a growing number of young families who are actively involved in the life of the church.

There is a variety of sheltered and supported living accommodation in Knowle, including care homes for the elderly, a refuge for young mothers and their babies and communal houses owned by charitable organisations. These all provide further pastoral care and outreach opportunities, not yet fully explored by the church.

The parish is well served by local amenities, such as a range of shops and supermarkets, doctor, dental and veterinary surgeries, good primary and secondary schools, nursery and pre-schools. There is also plenty of opportunity for exercise and leisure, with a cricket club, bowls club, gym, tennis courts, and a park with a café and community garden, all within a short walk from the church and vicarage.



MEET THE TEAM



Chris Dursley
Licensed Lay Minister



Steve Purnell
Licensed Lay Minister



Frank Tucker
Licensed Lay Minister



Rev. Phil Manning
Curate



Becky Wearne
Church Warden



Richard Hensman
Church Warden



Jan Coombes
Safeguarding Officer



Martin Turnbull
Music Director,
Organist



Claire Hensman
Hall Manager &
Sunday School
Leader



Beth Herbert
Parish Administrator

LIFE AS A CHURCH

'I love the atmosphere. It is a very welcoming place; friendly, smiley, lovely people, all contribute to this; very down to earth people! All types of worship, for all types of people.'

We have an active and committed team, comprising a full set of church officers, a curate-in-training, three LLMs, music director, administrator and pastoral care co-ordinator. You can find our stories at Who We Are - Meet the team at St. Martin's.

<https://www.achurchnearyou.com/church/11696/page/60923/view/>

St Martin's values inclusion and welcome to all, including for LGBTQI+ people. Our PCC and wider congregation would be supportive of our priest-in-charge beginning to use the prayers and services set out in Prayers of Love & Faith.

PATTERN OF WORSHIP

We are a thriving and growing church that has a 'big heart,' to welcome anyone in. Our congregation represents diversity in age, gender, race and sexuality. We endeavour to support everyone on their faith journeys by having a monthly pattern of services on a Sunday morning, which offer different 'ways in' to worship.

Every Sunday at 8.30am there is a simple, spoken Holy Communion service with a sermon and typically a congregation of around twenty. This was once attended only by older members of the congregation, but now includes a wider range of

people, who love the simplicity of this service.

'The children really enjoyed Café Church, but I do love the peace and tranquillity of the 8.30am service!'

On the 1st and 3rd Sundays of the month we have a Sung Eucharist at 10.30am, celebrated at the high altar with incense, sung liturgy, and hymns, supported by our robed choir and serving team.

During these services our children's group 'Sunday Spirit' meets in the hall.

On the 2nd Sunday of the month, we have an informal Café church at 10.30am. We listen to a Bible passage and a reflection over breakfast, taking time for discussion, prayer and sung worship. There are activities for the children and young people.

On the 4th Sunday of the month at 10.30am, we have our 'All-Together' service; a simplified communion Service with an interactive talk for all ages.

Whilst we are pleased with our pattern of worship, we recognise there is room for development, so would welcome a new Priest in Charge, with fresh ideas on how to help us to worship, as an all-age family.



Every Friday we have a service of Morning Prayer at 9.30am. This is led by a different member of the Ministry Team each week and has an average attendance of ten people. During this service there is an opportunity for discussion, prompted by the set readings for the day, as well as a shared time of prayer. This is a safe space for exploring difficult questions about faith and its relationship to daily life. One person, described Morning Prayer recently as

'An opportunity for exploring and discussing the Bible, but Friday mornings are more than that. Philosophical debate, thought provoking, a supportive group and a coming together after the service over croissants and coffee. Everyone is welcomed equally and without judgement!'

After each of our services we gather for conversation over refreshments. This is a great space to make anyone visiting the church for the first time feel welcome.



ATTENDANCE PATTERNS

For information about the patterns of attendance at services throughout the year, please see the SfM Dashboard at the end of the profile. Information about attendance at special festivals and services can be found in the tables below.

The following table shows attendance at:

- Service of Light and Easter Morning
- Christmas Eve Crib service, Midnight Mass and Christmas Morning

Attendance across main services	2022	2023	2024
Easter Eve/Day	-	121	142
Christmas Eve/Day	217	267	324

The following table shows attendance trends for other special services throughout the year

	2022	2023	2024
Festival of 9 Lessons with Carols	109	164	254
Commemoration of the Faithful Departed	30	11	22
Remembrance Sunday	71	75	75

ST. MARTIN'S SERVING TEAM

We have a lively and enthusiastic team of fourteen servers made up of eight adults and six young people. Between them they support our Sung Eucharist services with a robed team of Thurifer, Crucifer, Acolytes and Boat Bearer. One robed server also supports the All-Together Communion on the 4th Sunday of each month.

MUSIC AND MUSICAL TRADITION AT ST. MARTIN'S

The church is fortunate to have a small, well-balanced, robed choir that can sing in four parts. It is led by a musical director, who is a professional and experienced musician. The choir sings at three Sunday Eucharists each month, as well as at special services, especially during Holy Week, Easter and Christmas.

The choir will also sing for weddings and funerals and other festivals when requested. Their repertoire includes traditional music, as well as more contemporary pieces.

The church has an the excellent two-manual organ. There is also a small grand piano, which is used during some services.

'I love being a part of a 4-part choir, which is rare for a church these days!'



PROVISION FOR CHILDREN AND YOUNG PEOPLE

Sunday Spirit (1st and 3rd Sundays) - a worship group for primary school aged children using the 'Roots' material to facilitate reading the Bible, discussion and prayer. There are craft activities or a game to help children engage with the topic.

Messy Church (3rd Friday) – approximately twenty children plus their adults regularly come along to Messy Church each month, whilst there are others who join in, on a more ad hoc basis. Messy Church attracts a mixture of families, some who have existing contact with the church, whilst for others, this is their only contact with St. Martin's. We have found that Messy Church can also be an entry point to coming along to Sunday morning services, Baptism and Confirmation.

Bears and Prayers (4th Wednesday) - a simple monthly act of worship for pre-school aged children and their carers, with a Bible story, singing, praying and a craft activity, followed by refreshments.

Provision for Young People in Year 7 - Year 11

At the present time we have no specific provision for young people in Year 7 and above. We are however, helping to launch an ecumenical Youth Alpha course in the local area at the end of February, which we hope will lead to further joint activities. There is a growing desire to provide for this age group to gather regularly.

It would be ideal to have a Priest in Charge, who has both an interest and skill for facilitating this area of ministry.



PASTORAL CARE

DISCIPLESHIP GROUPS

These groups mainly run during Lent and Advent. We gather to discuss matters of faith, using a variety of small group materials. These are led by members of the Ministry team.

PASTORAL CARE

Our Pastoral Care Team are a small group of volunteers, who help offer pastoral support to people in our congregations and parish through home visits, regular phone calls and conversations. Alongside our own training days, which focus on listening skills and appropriate boundaries, our pastoral care volunteers have an enhanced DBS and have attended the relevant Diocesan Safeguarding training, required for the role. They are under the oversight of the Incumbent and the Pastoral Team Coordinator, who is a qualified Relationship and Family Counsellor.



GREEN ACTION

The church prays for the environment in the intercessions on the 1st Sunday of each month. Green themes are explored in both Sunday Spirit and Messy Church, and we have a green tips board in the church. We have earned the A Rocha Bronze Eco Award; themes of climate change and ecology are included in our services throughout the year.

Last year a survey was carried out on the church and hall, with recommendations of how we could move towards being carbon neutral. This is one of the Diocesan objectives for 2030, in its Transforming Church Together Strategy. The cost of implementing these recommendations seems currently insurmountable. We would welcome a priest-in-charge who will navigate these challenges with us.



COMMUNITY AND OUTREACH

Café Reconnect – each week we open a pay-as-you-can café for people in our local area. Those who regularly come to Café Reconnect find a sense of community and support, not only from the church members present, but from each other; it's a warm and welcoming space, where people can share food together, talk and make new friends!

'*Is it really time to go already?*' is a phrase that can often be heard, as we begin to clear away each week!

Southlands Service – once a month we offer a simple service, in a local residential care complex for between ten and fifteen residents.

There are several other care complexes in the parish, which may appreciate similar support in the future.

The Foodbank – space at the back of church is provided for donations to a local foodbank.

CHRISTMAS AT ST MARTIN'S

Each Christmas we value opportunities to be generous in collaboration with the Salvation Army through our Gift Service and with our local school. For the past three years, St. Martin's has supported our local community primary school, by providing food hampers and Secret Santa Gifts for families in need, identified by the school.

I would like to say a massive thank you to all at St Martin's Church. Through their generosity, thoughtfulness and care, they delivered and provided 23 families with MANY treats and delicious food for Christmas day. Amazing!

Knowle Park School's newsletter

Christmas Bazaar and Summer Fair

Our treasured annual Christmas Bazaar and Summer Fair are long running community and fundraising events. Each year they help us to connect with our community, whilst raising money to boost church funds, and great fun is had by all!

SOCIAL MEDIA

We have a regular social media presence on Facebook, thanks to our fantastic church administrator. This helps us to be visible and publicise events, as well as offering ways to pray at key moments throughout the year.



CONNECTIONS WITH LOCAL SCHOOLS

We have enjoyed a significant connection with the local primary school, Knowle Park, for many years. It is the only community primary school in the parish and is where most of our church connected children go to school. Despite being a school with no religious designation, there is a strong desire for partnership with us.

Currently our curate takes assemblies throughout the year. Our new Priest in Charge would ideally bring ideas, enthusiasm and a desire to strengthen this connection further, as well as re-establishing our links with Cleve House, a small independent school in our parish.

SUNSHINE PRE-SCHOOL

Sunshine Pre-School is a small, family run local business, who have been serving the communities in Knowle and Whitchurch for over 25 years. We are blessed to have one of its settings meetings in our Parish Hall, five days a week in term time. Over the years we have built up strong relationships with both the owners and the staff who work at the Pre-School.

It is a joy to welcome the children from Sunshine's into Church, to mark the major festivals, such as Christmas and Easter, with a very simple, age-appropriate act of worship, or to simply take them on an exploratory walk around this special sacred space, which often seems vast to these very small children.



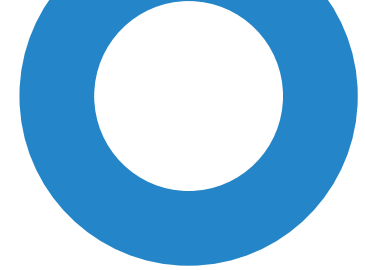

BUILDINGS AND FINANCE

THE CHURCH BUILDING

The last quinquennial inspection took place in November 2023. This reported the overall condition of the church and grounds as being well cared for and in good repair. The inspection did identify a few items in need of attention.

The church and its attractive grounds are maintained by an enthusiastic and dedicated team, from the congregation. There are regular working parties that tackle everything from spring cleaning the church, to repointing the buttresses and oiling the Nave floor!



The current layout of the church does not quite meet our needs and ideally some remodelling and upgrading would enable us to better provide opportunities and spaces for different groups during the week.

CHURCH HALL

St Martin's has a large hall, which was built at the same time as the church. Currently the hall's main user is Sunshine Pre-school, who use it from Monday to Friday during term time. This is a valuable connection and we welcome the children from the pre-school into church several times a year.

The hall is hired out in the evenings to dance and fitness classes and Knowle Table Tennis Club. It is available for hire at weekends to those who have a connection with the church or the Pre-School. Whilst the building is structurally sound, it is of an age where small issues require regular attention. We are fortunate to have a volunteer caretaker who undertakes minor repairs and decoration. The hall is cleaned weekly.



THE VICARAGE

The Vicarage is by the church and has its own parking and garden. It is a spacious, detached four-bedroom house, built in the 1980s. On the ground floor there is a generous sized lounge, dining room, kitchen, study, WC, and utility room. Four bedrooms and a bathroom are on the first floor. The property has gas-fired central heating and is double glazed, and PV will be added this year with a hot water tank solar diverter.

The well maintained mature gardens have raised decking and seating areas in the secluded rear garden. There is a single garage with a parking space and a reserved parking space for vicarage use, opposite the front drive.



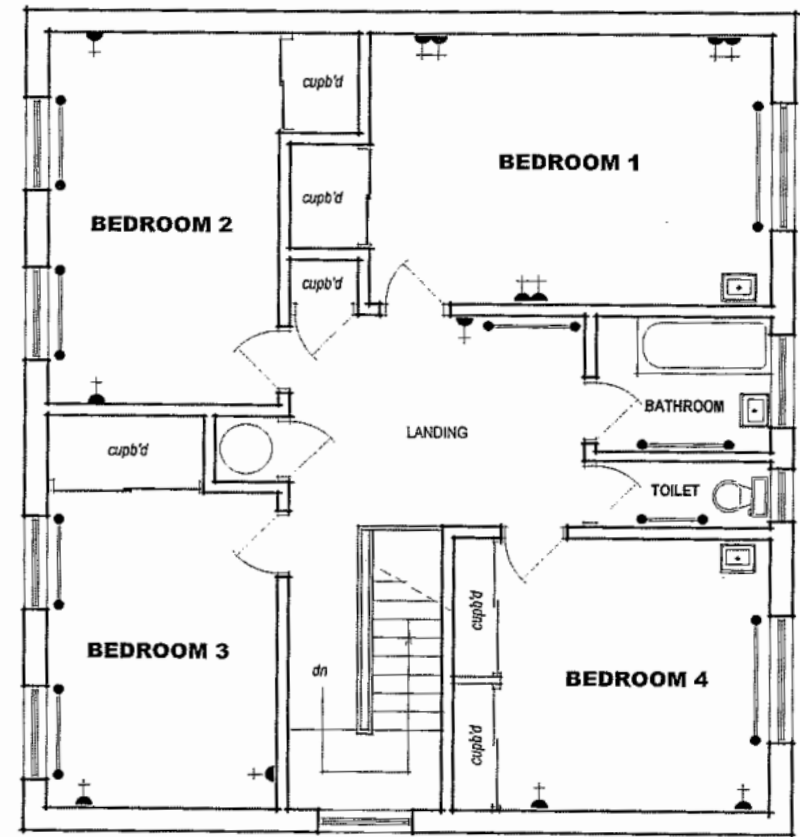
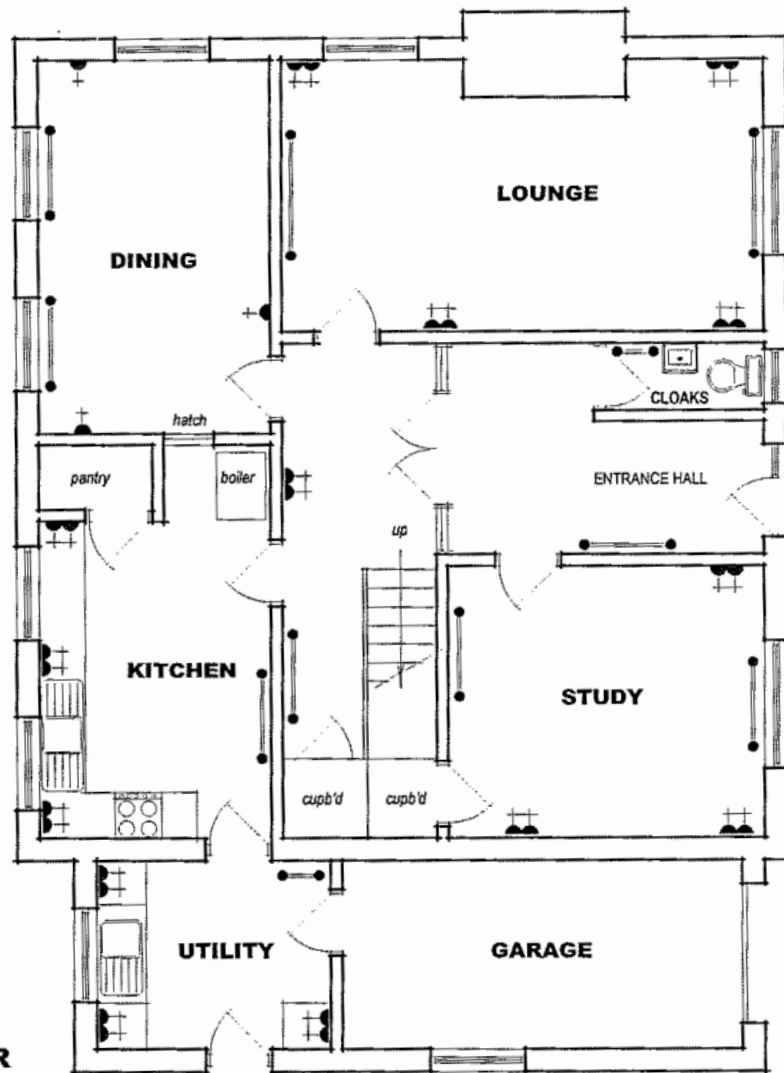

CHURCH FINANCES

Church finances continue to be challenging, particularly with the rising costs of utilities, which has seen our heating and lighting expenditure increase dramatically. Whilst we have continued to pay much of our Parish Share over the past two years, this has had to be at a reduced amount.

The PCC is acutely aware that we need to find ways of increasing our income, not least so that we are more able to pay the full amount of our Parish Share, but also to ensure that we can continue our mission and outreach activities.

We see this year's APCM and the Electoral Roll revision, which accompanies it, as an opportune time for raising awareness of our financial situation and church governance, both for longstanding members of the congregation and those who have joined us in recent years.

Further information on our financial position is at the end of the profile



PERSON SPECIFICATION

QUALIFICATIONS / TRAINING

Essential

- Ordained priest within the Church of England, or a Church in communion with it, or a Church whose orders it recognizes.
- Have satisfactorily completed Initial Ministerial Education

EXPERIENCE

Essential

- Impactful competence in the core ministry of a priest who has been selected as incumbent status.
- Oversee and deliver worship, preaching and discipleship provision within the modern catholic tradition which transforms lives and the church.
- Demonstrate team leadership which holds the space in which collaboration can flourish, sharing ministry as appropriate with others.

KNOWLEDGE/ SKILLS AND COMPETENCIES

Essential

- Able to oversee and participate in work amongst the under-18s, including worship for all ages and discipleship pathways.
- Fully trained in and committed to safeguarding the whole community and able to lead in nurturing a safeguarding culture and the implementation of safeguarding policy and practice.
- Able to lead on strengthening community links and building on them to further the Kingdom of God.
- Able to provide support and encouragement, to draw up a recovery plan to address our budget deficit.

GENERAL ATTRIBUTES

Essential

- Someone whose identity is grounded in a lively faith in Jesus, with a passion for sharing God's love
- A commitment to full engagement with Deanery and Diocese, including the opportunities afforded by 'Transforming Church. Together'

National Census 2021 Dashboard for the Parish of Knowle: St Martin in the deanery of BRISTOL SOUTH

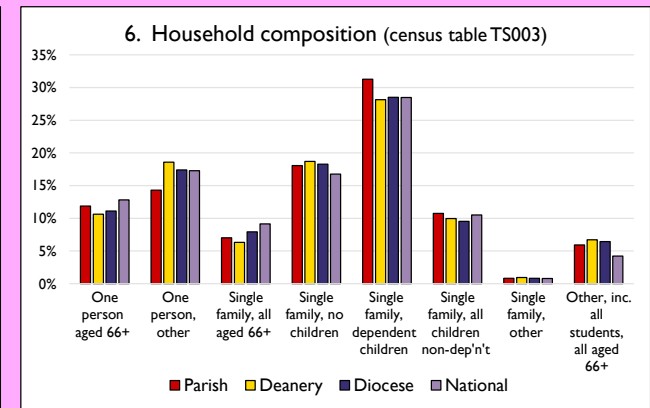
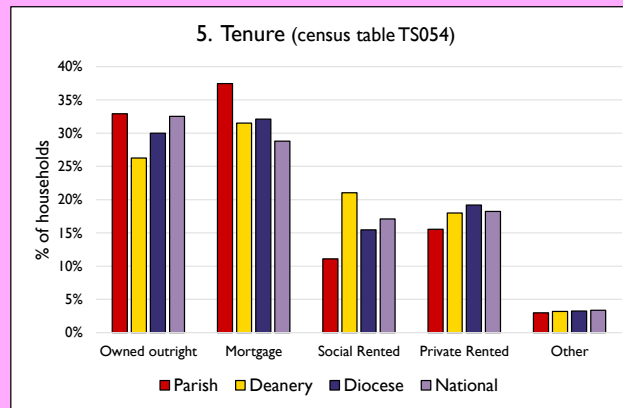
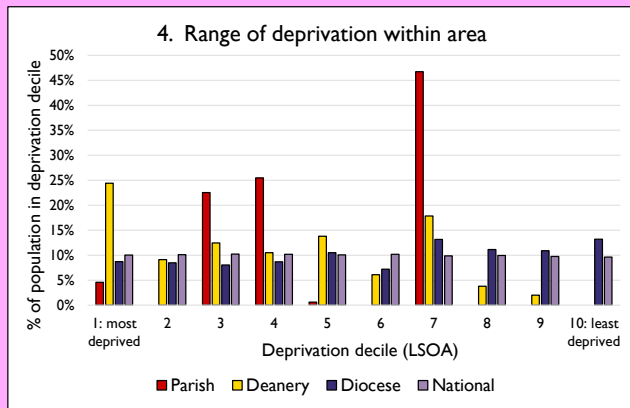
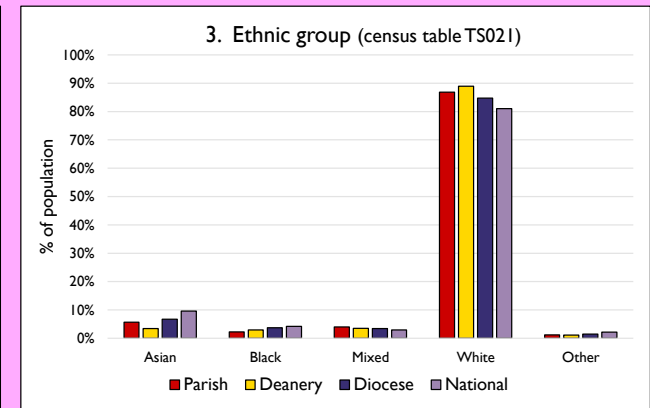
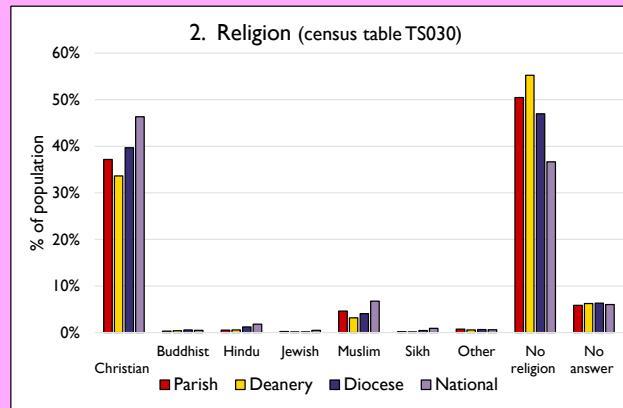
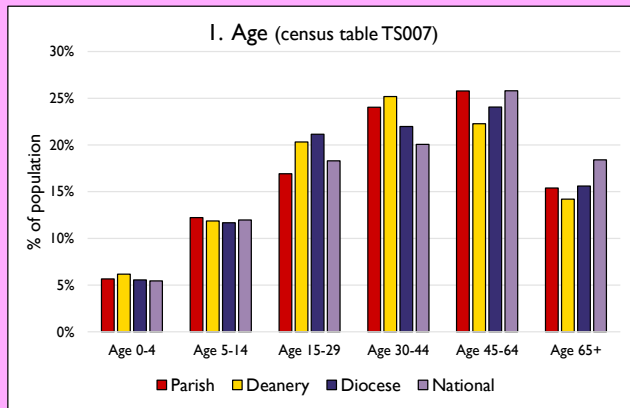

7. 2019 Deprivation Statistics

Index of Multiple Deprivation (IMD), domains, and subdomains

IMD - overall deprivation 30%			
Employment	26%	Crime	8%
		Health	20%
Income	27%	Education	23%
Income: Children	36%	Children & Youth	41%
Income: Old people	20%	Adult Skills	30%
Housing & services	84%	Living Environ't	56%
Local services	97%	Indoors	54%
Affordability	13%	Outdoors	27%

Shading shows severity of deprivation compared to other parishes, colour-coded by decile.
E.g., a figure of 25% means that 25% of parishes are more deprived than this parish.

	Parish	Deanery	Diocese	National
Population	7,946	161,595	1,064,844	56,506,784
Occupied households	3,161	67,645	435,054	23,444,438
Living in households	7,922	160,442	1,043,877	55,542,946
Average household size	2.51	2.37	2.40	2.37
Living in communal estab'ts	24	1,153	20,967	963,838

Parish, Deanery and Diocese codes

Parish	550041	St. Martin Knowle
Deanery	55101	BRISTOL SOUTH
Diocese	5	Bristol

Notes & definitions

Census and deprivation statistics have been mapped onto parish boundaries, and are therefore approximations. Census data as shown in figures 1-3, 5, & 6 are derived from the National Census 2021 produced by the Office of National Statistics (ONS). For details from ONS see: https://www.nomisweb.co.uk/sources/census_2021. Deprivation statistics are derived from the English Indices of Deprivation 2019, produced by the Ministry of Housing, Communities & Local Government. More details can be found at: <https://www.gov.uk/government/statistics/english-indices-of-deprivation-2019>. Deprivation statistics are published at LSOA level. Figure 4 shows how the population of each area is split across LSOAs, categorised by LSOA deprivation decile. For more detailed parish census and deprivation information, see: <https://www.churchofengland.org/about/data-services/resources-publications-and-data#na>. For an interactive map showing parish deprivation and census statistics, see: <http://arcgis.is/1RaS4CS>.

Parish deprivation statistics in figure 7 are colour-coded by parish deprivation decile:

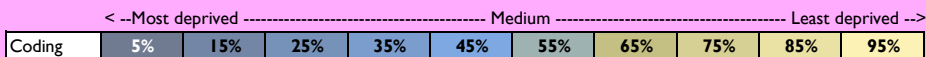

Finance Dashboard for the Parish of Knowle: St Martin in the deanery of BRISTOL SOUTH

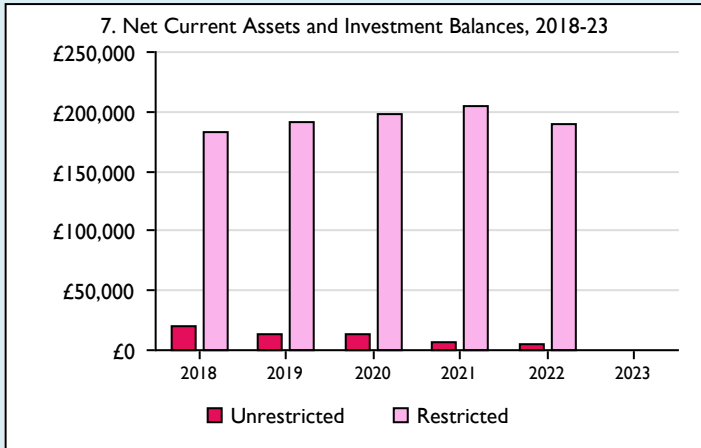
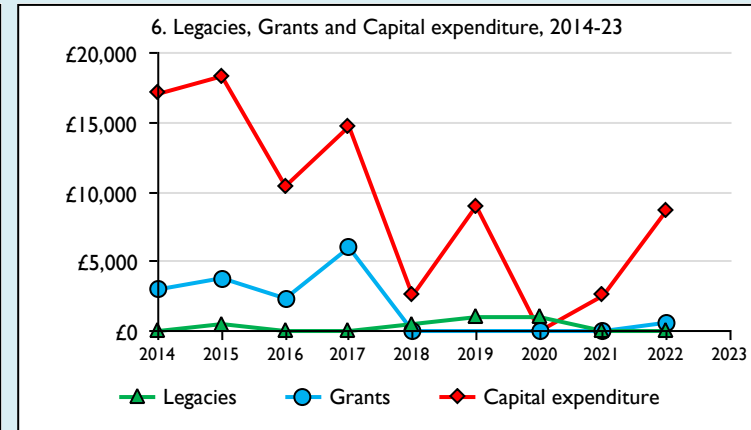
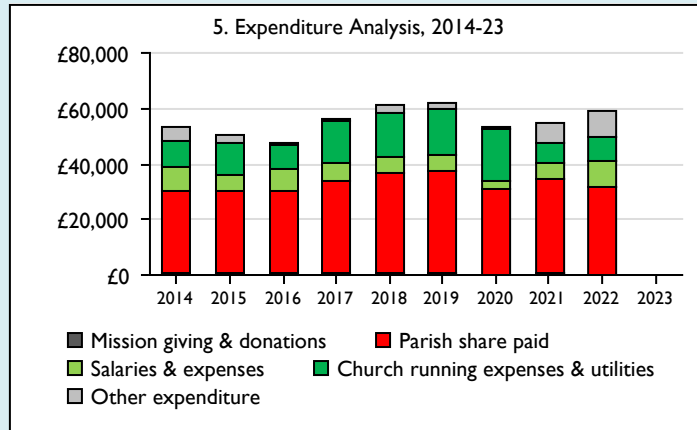
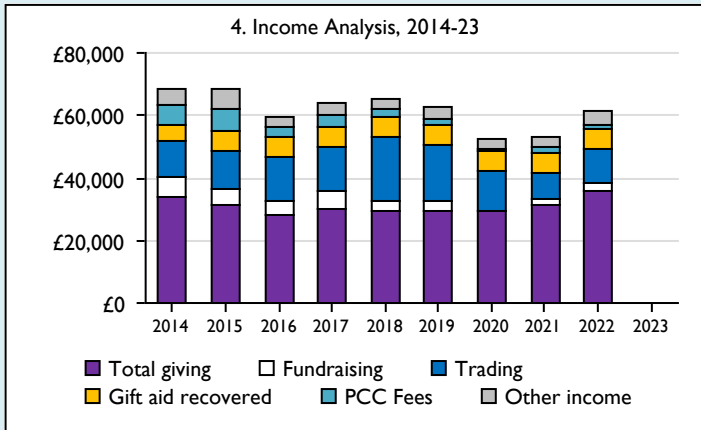
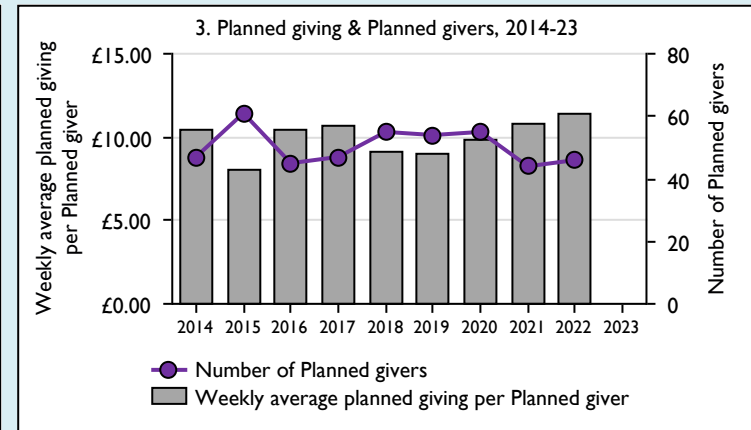
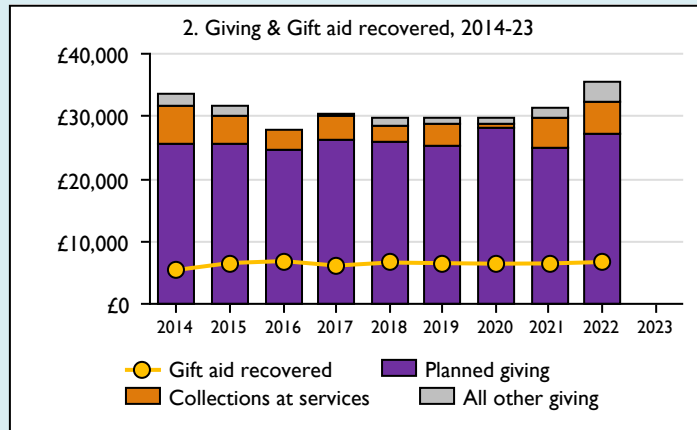
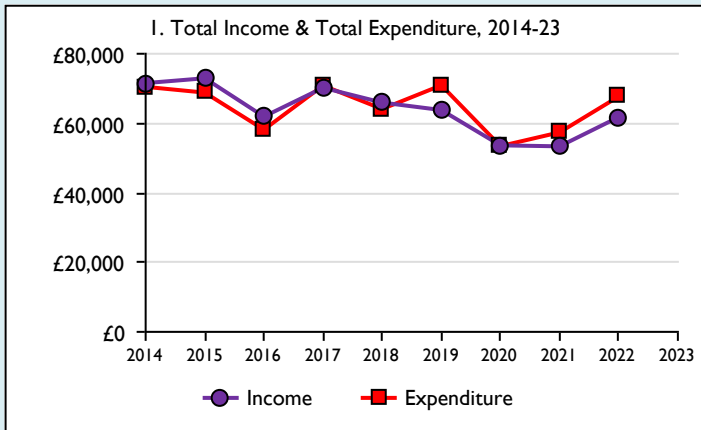

Weekly average planned giving per planned giver (2023)
 Parish: nan
 Diocese: 0.0

Number of churches in parish (2023): 1
 Parish code: 550041

Notes & definitions
 This dashboard contains figures as submitted by churches currently in the parish; gaps may be the result of missing returns.
 Graph 2 shows a detailed breakdown of the **Total giving** figure in graph 4.
 Graph 3: **Planned giving** = Tax efficient planned giving + Other planned giving; **Planned givers** = Tax efficient planned givers + Other planned givers.
 Graph 4 shows income other than grants and legacies.
 Graph 4: **Total giving** = Tax efficient planned giving + Other planned giving + Collections at services + All other giving, including special appeals.
 Graph 4: **Other income** = Dividends, interest, income from property + Any other income.
 Graph 5 shows expenditure other than capital expenditure.
 Graph 5: **Other expenditure** = Fund-raising activities + Mission and evangelism costs + Cost of trading + Other expenses.
 Graph 5: **Running expenses & utilities** also includes governance costs.
 Graphs 1-6: Unrestricted and Restricted amounts have been combined.
 For further definitions please see the guidance notes attached to the Return of Parish Finance:

Variations from year to year may be the result of changes in the number of churches that submitted returns, or changes in parish/benefice structure.
 Number of churches included in returns: 2014 1;2015 1;2016 1;2017 1;2018 1;2019 1;2020 1;2021 1;2022 1;2023 1.

Produced by Data Services, Church House, Great Smith Street, London SW1P 3AZ. Date of production: 04/12/2024.

Every effort has been made to ensure that data are reliable. We would be pleased to be notified of any significant errors or omissions by email to statistics.unit@churchofengland.org

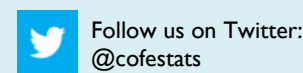

SfM Dashboard for the Parish of Knowle: St Martin in the deanery of BRISTOL SOUTH

1. Attendance Summary, 2014-23

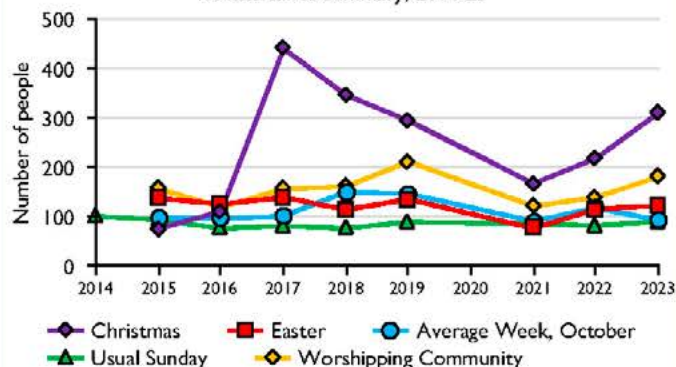

2. Worshipping Community, 2016-23

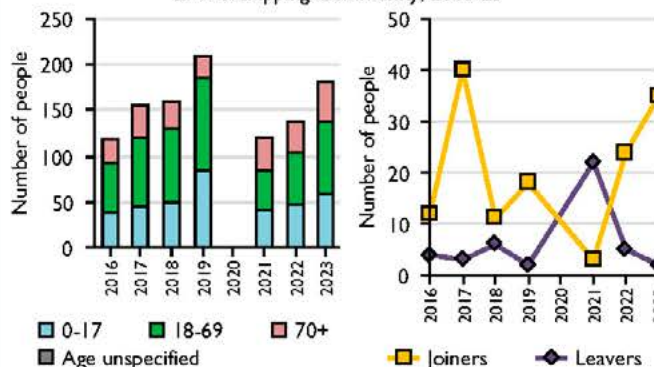

Parish Census and deprivation summary

Parish population (2021): 7946

	Parish	Diocese	National
% aged 0-19	23%	23%	23%
% aged 20-44	35%	37%	33%
% aged 45-69	30%	28%	31%
% aged 70 & over	11%	11%	14%
% Christian	37%	40%	46%
% non-Christian religion	6%	7%	11%

Parish deprivation rank (IMD 2019): 3674

(1=most deprived parish in the Church of England, 12,239=least deprived)

For more detailed census & deprivation info: see <http://arcg.is/1RaS4CS>

<https://www.churchofengland.org/researchandstats> and

<http://www2.cuf.org.uk/poverty-england/poverty-map>

Number of churches in parish (2023): 1

Parish Code: 550041

3. Usual Sunday Attendance, 2014-23

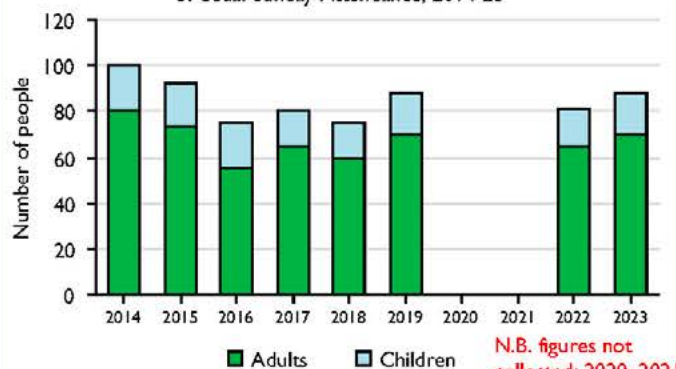

4. Average Weekly Attendance, October, 2014-23

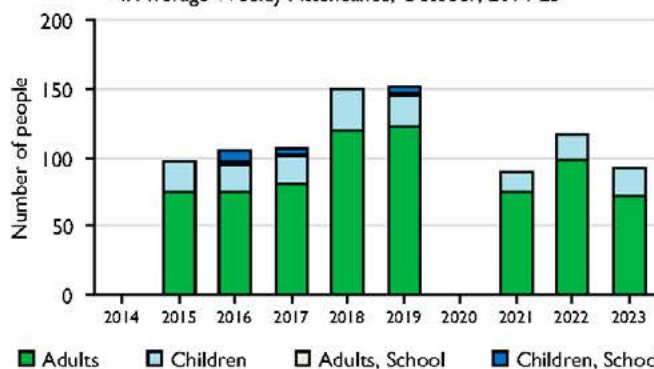

5. Percentage Children, 2014-23

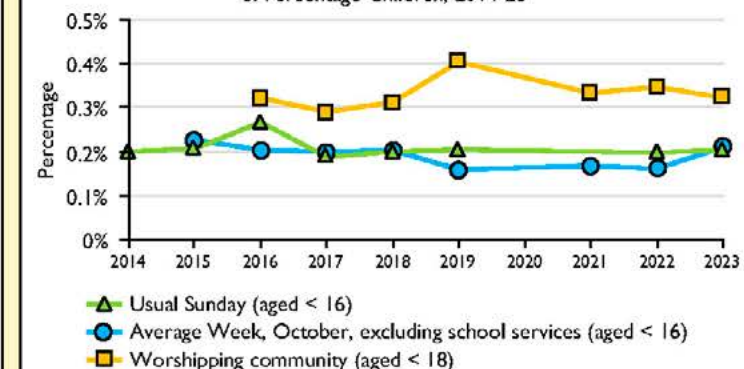

6. Baptisms, marriages and funerals, 2014-23

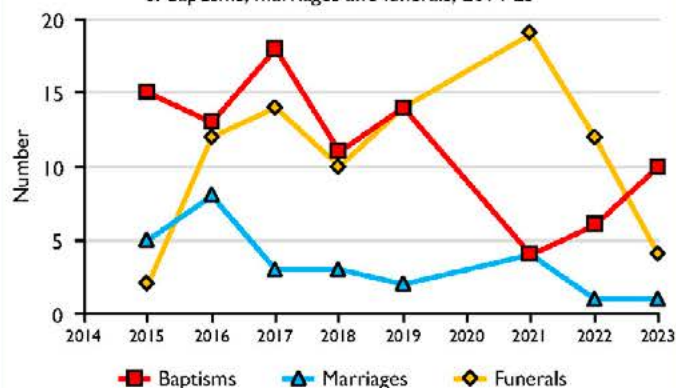

7. Electoral Roll, 2015-23

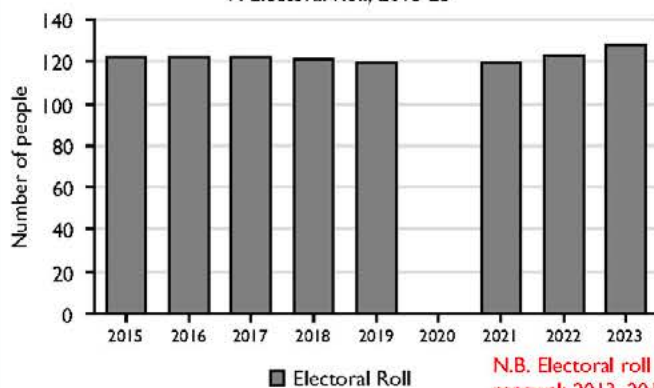

This dashboard contains figures as submitted by churches currently in the parish

Attendance statistics: taken from annual Statistics for Mission returns.

Average weekly attendance: attendance at Sunday and midweek church services & fresh expressions in October; Figs 1 & 5 do not include attendance at services for schools.

Easter: Easter Eve & Easter Day; Christmas: Christmas Eve & Christmas Day.

Baptisms: all baptisms & thanksgivings.

Marriages: marriages and services of prayer & dedication after civil marriages.

Funerals: those held in church & at crematoria/cemeteries.

Because of pandemic-related church closures, Easter figures were not collected in 2020.

Census data: taken from the 2021 national Census.

Deprivation statistics: IMD taken from the English Indices of Deprivation, published by the Ministry of Housing, Communities & Local Government, Sept 2019.

The above statistics have been mapped onto parish boundaries so are approximations.

For more information, see: <https://www.churchofengland.org/researchandstats>

Variations in attendance from year to year may be the result of changes in the number of churches that submitted returns, or changes in parish/benefice structure.

Number of churches included in returns: 2014 1;2015 1;2016 1;2017 1;2018 1;2019 1;2021 1;2022 1;2023 1.

Produced by Data Services, Church House, Great Smith Street, London SW1P 3AZ. Date of production: 04/12/2024.

Every effort has been made to ensure that data are reliable. We would be pleased to be notified of any significant errors or omissions by email to statistics.unit@churchofengland.org



Follow us on Twitter:
@cofstats



PARISH CONTACT

Do be in touch with Christopher Bryan the Archdeacon of Malmesbury if you would like to discuss this opportunity.

christopher.bryan@bristoldiocese.org

